



LB

Loporto Browne

— RESIDENTIAL —



# Chatsworth Road, NW2

£1,100,000

3 2 0



- Guide Price: £1,000,000 to £1,100,000







**Guide Price: £1,000,000 to £1,100,000**

LB Residential are proud to be instructed on this semi-detached, architecturally designed, freehold house, the property comprises of three double bedrooms and three bathrooms all ensuite and situated on three levels. The property has been architecturally designed and has herringbone wooden floors, exposed steels, modern kitchen and a reception room which is large enough for dining and entertaining. The house benefits from a pantry/laundry room and the reception room leads on to a 20-meter garden private garden.

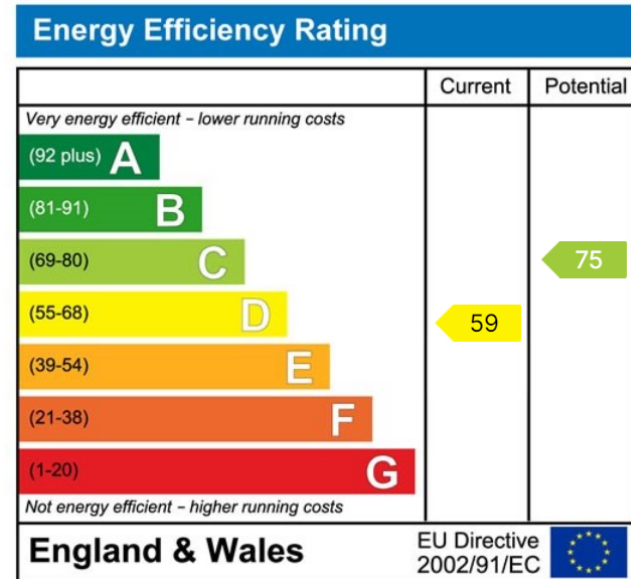
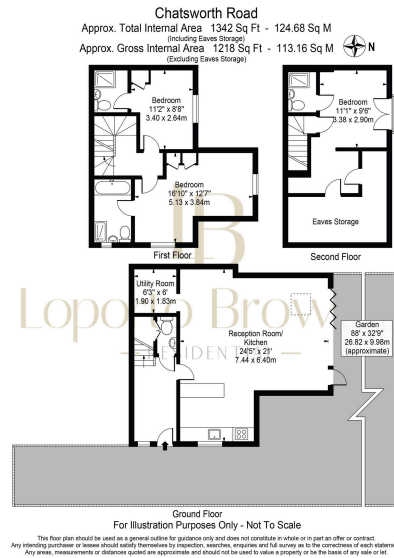

**LB Residential**  
 Grand Union Studios  
 332 Ladbroke Grove  
 W10 5AD

Email: [hello@lbresidential.co.uk](mailto:hello@lbresidential.co.uk)  
 Web: [www.lbresidential.co.uk](http://www.lbresidential.co.uk)  
 Tel: 0203 062 6262